

SOUTH DAKOTA
 DEPARTMENT OF GAME, FISH AND PARKS
 SOUTH RED IRON LAKE
 MARSHALL COUNTY

AERIAL PHOTO NO: CBU-5M-37
 PHOTO DATE: 8-16-53
 SECTION 20, 29, 30-TWP 126N-RGE 53W
 B.M: CULVERT (WATER 16 INCHES BELOW TOP OF CULVERT)
 PLANIMETERED ACREAGE: 610.2
 MILES OF SHORELINE: 7.5

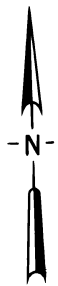

- SYMBOLS**
- SHORELINE (solid line)
 - DEPTH CONTOUR (dashed line)
 - ROADS
 - HARD SURFACE (thick solid line)
 - GRAVEL (dashed line)
 - TRAIL (dotted line)
 - BENCHMARK -- BM
 - MARSH
 - GRAZING LAND -- GL
 - CROPLAND -- CL
 - WOODED -- W
 - PARTIALLY WOODED -- PW
 - CUTBANK C -- C
 - ROCKY SHORELINE R -- R
 - SANDY SHORELINE S -- S
 - GRAVELLY SHORELINE
 - PUBLIC ACCESS -- PA
 - BRIDGE (line with two short perpendicular bars)
 - BUILDINGS (small squares)

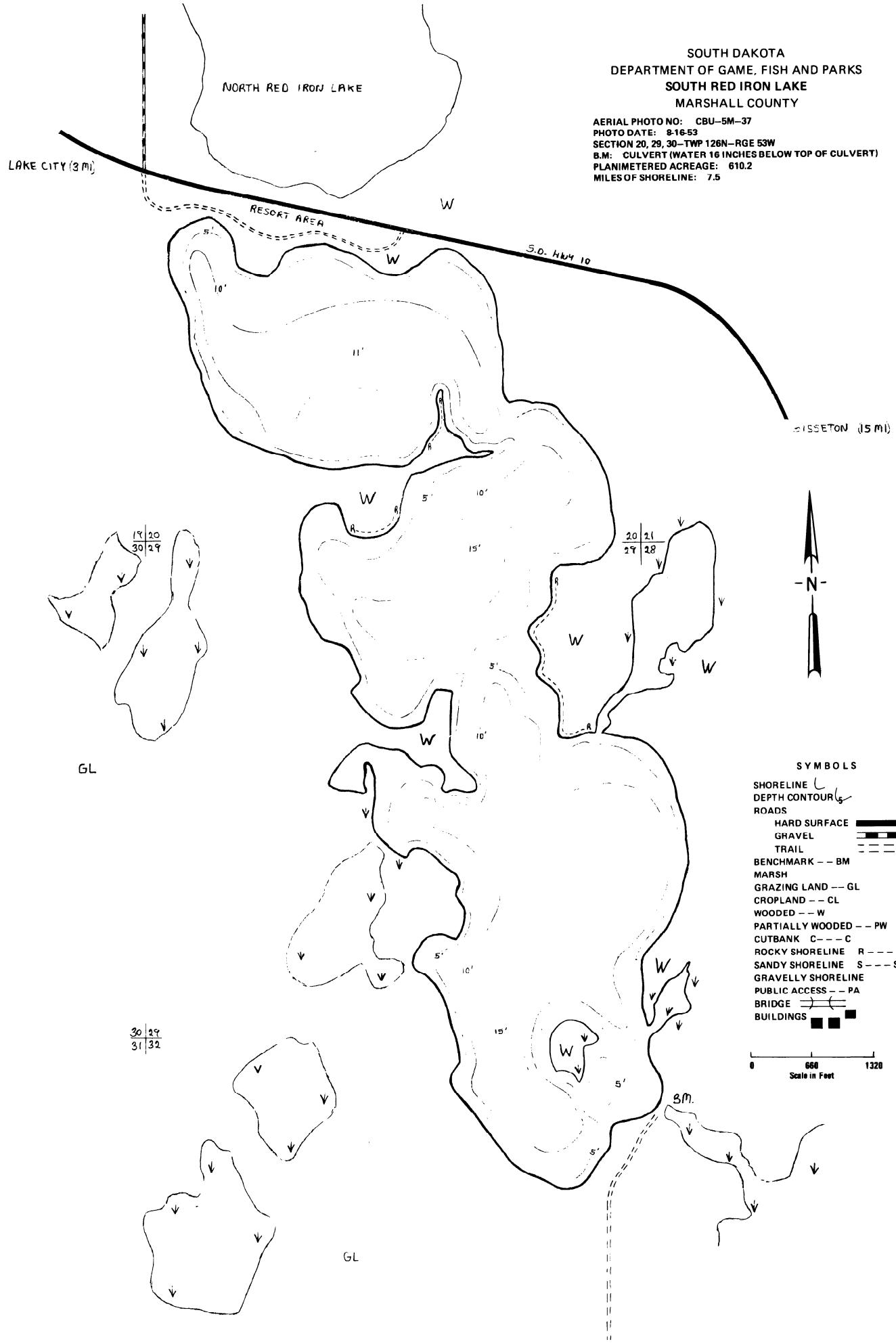